

PLAN 3P SCALE 1:10 A3

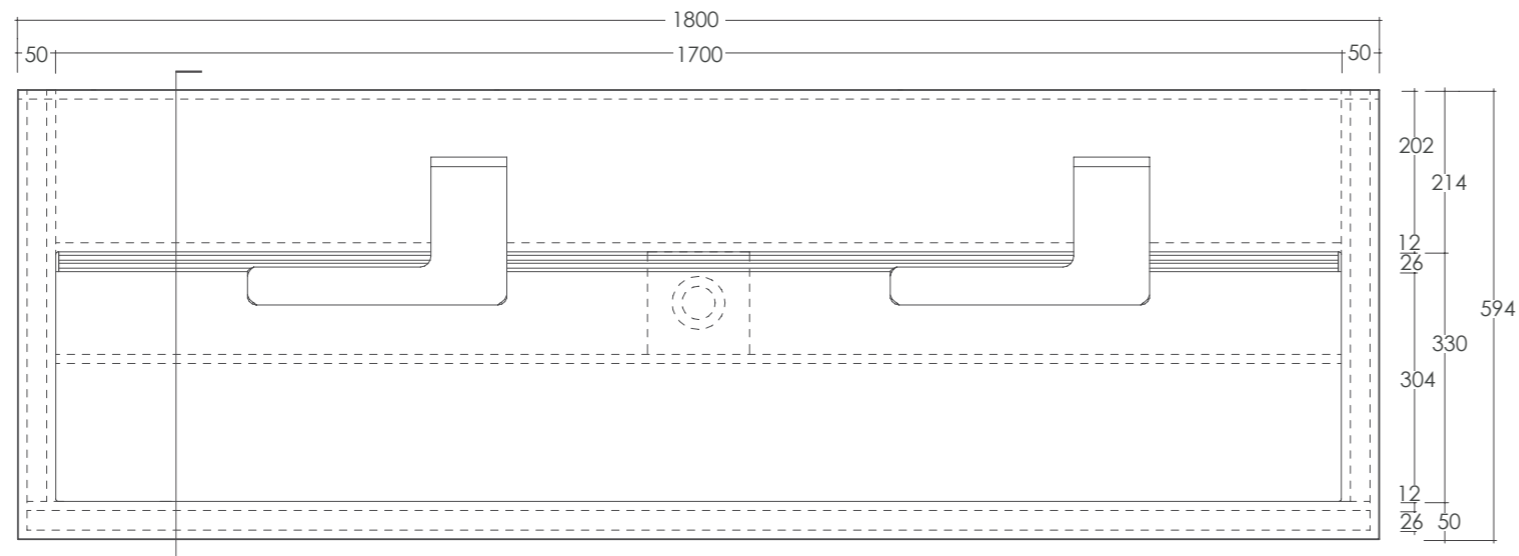

PLAN 2P SCALE 1:10 A3

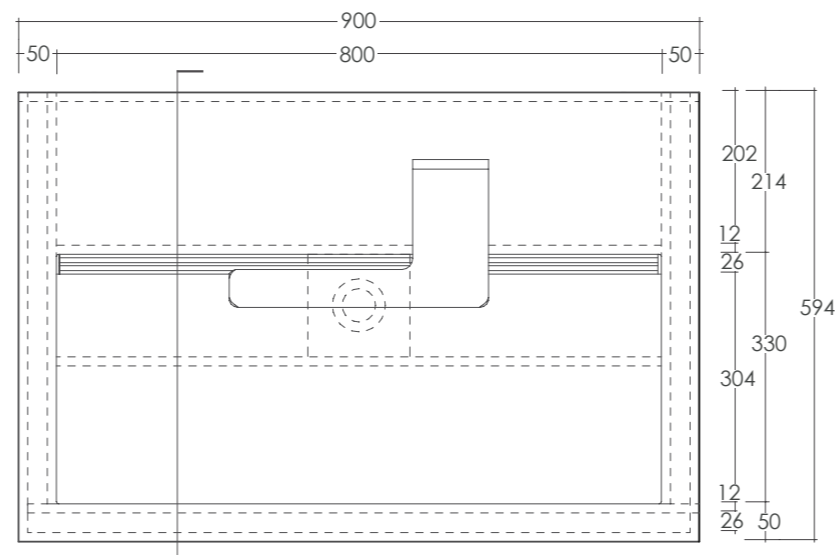

PLAN 1P SCALE 1:10 A3



BRADLEY: WashBar WB2

**SPECIFICATION DETAILS**

- Australian designed
- Fabricated in every state
- STARON:
  - 2/3 natural mineral and 1/3 acrylic
  - Silica and polyester FREE
  - Greenguard & Greenguard Gold certified
  - 10 Year Warranty
- Unit available in all Staron colours, including mixed combinations
- Aluminium grate supplied in:
  - satin silver grey
  - satin black
  - mill finish (allowing further custom anodising/powder coating)
- All dimensions flexible
- Adapt design to suit joinery units
- Modify form to accommodate:
  - disability rails
  - parcel shelves
  - towel/soap dispensers

**staron**  
Solid Surfaces

**AUSTARON**  
SURFACES

AUS: 17/30 Heathcote Rd Moorebank NSW 2170  
 NZ: 94 Nevay Rd, Karaka Bays Wellington 6620  
 phone: 02 9822 7055  
 email: sales@austaron.com.au  
 web: austaron.com.au

**staron**  
Example

TITLE **STARON GRADIENT BRADLEY WB2**

SOLID SURFACE WASHPLANE - FLEXIBLE DIMENSIONS  
 COMPATIBLE WITH BRADLEY WASHBAR WB2

DWG NO. STARON EXAMPLE - 008

DRAWN SG

DATE 01.10.21

CHK'D AS

DO NOT SCALE DRAWING

SHEET

A3

**DESIGN REMAINS PROPERTY OF AUSTARON SURFACES AND CAN ONLY BE USED WHEN SPECIFYING STARON SOLID SURFACE.**

Architect to determine design suitability.  
 Contact your Staron representative for any colour samples or technical information.

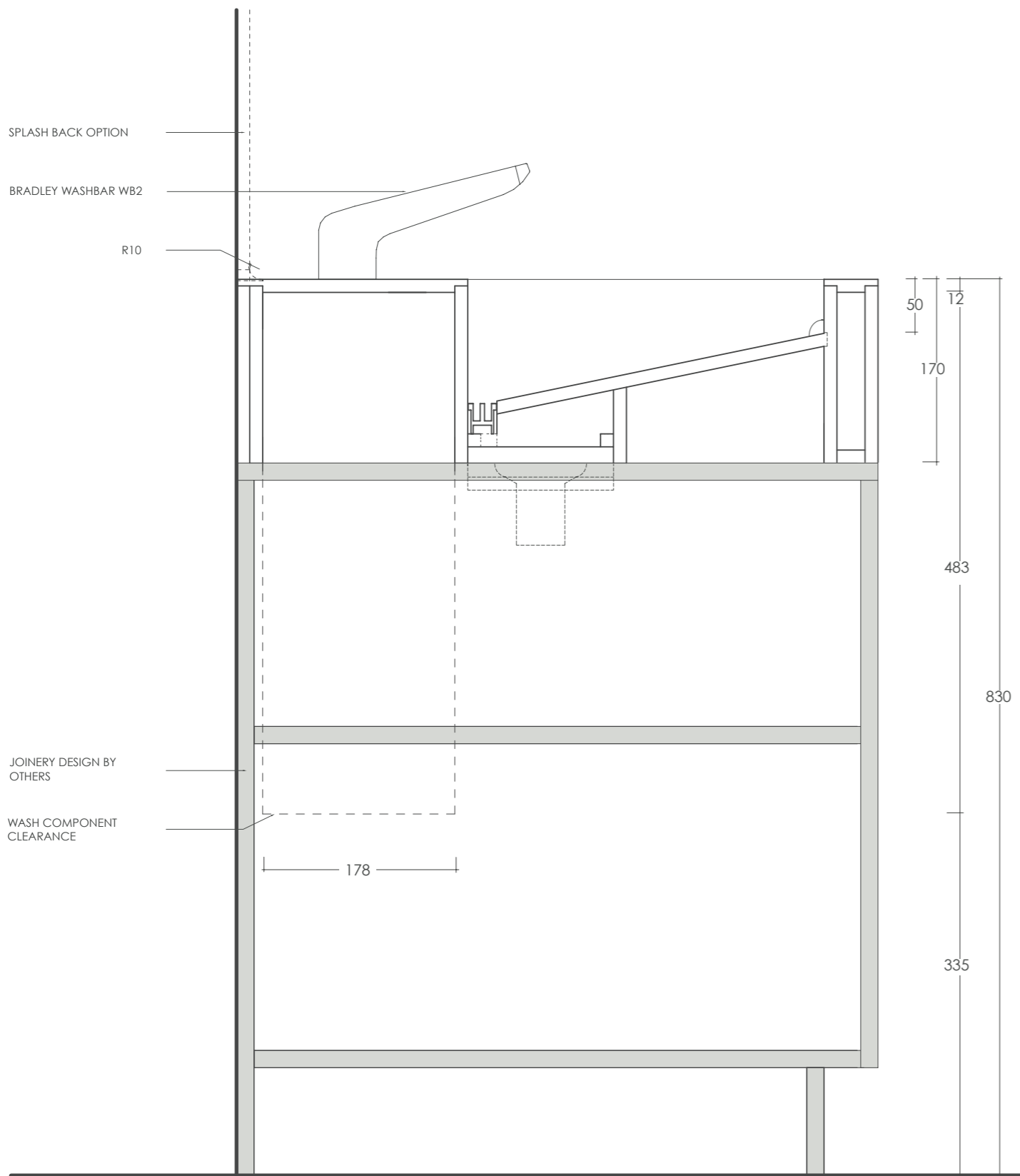
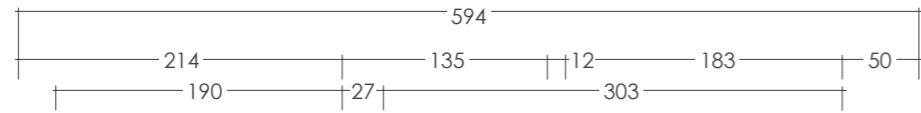

**STARON SUPPLIED COMPONENTS**

Components only available for use with Staron designs.

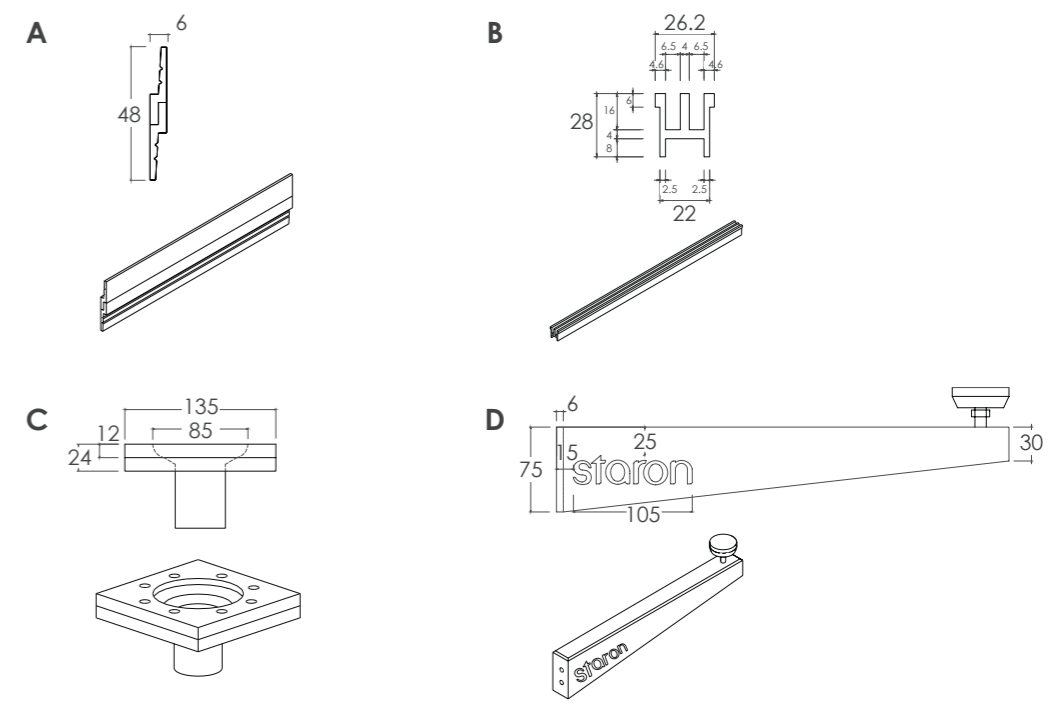

- A** STAINLESS STEEL SPLIT BATTEN - For securing washplane to wall
- B** ALUMINIUM GRATE - Aids easy cleaning & prevents jewellery loss
- C** WASTE OUTLET ASSEMBLY - Simple disassembly allows plumbing access
- D** STAINLESS STEEL BRACKET - Each bracket provides 100kg support

\*washplane designed to sit on top of joinery, with the addition of components **A & D** able to accommodate a wall mounted solution

**FABRICATION AND INSTALLATION**

- Manufacture as per fabrication requirements
- Recommended 1 waste outlet for every 2 taps
- Weight of unit approx. 36kg per lined metre
- Builder to ensure suitable wall strength to support

SECTION SCALE 1:5 A3

**staron**  
Solid Surfaces

**AUSTARON SURFACES**

AUS: 17/30 Heathcote Rd Moorebank NSW 2170  
 NZ: 94 Nevay Rd, Karaka Bays Wellington 6620  
 phone: 02 9822 7055  
 email: sales@austaron.com.au  
 web: austaron.com.au

TITLE	<b>STARON GRADIENT BRADLEY WB2</b>
	SOLID SURFACE WASHPLANE - FLEXIBLE DIMENSIONS COMPATIBLE WITH BRADLEY WASHBAR WB2
DWG NO.	STARON EXAMPLE - 008
DRAWN	SG
DATE	01.10.21
CHK'D	AS

DO NOT SCALE DRAWING

SHEET 2 OF 2

A3

**DESIGN REMAINS PROPERTY OF AUSTARON SURFACES AND CAN ONLY BE USED WHEN SPECIFYING STARON SOLID SURFACE.**

Architect to determine design suitability.

Contact your Staron representative for any colour samples or technical information.